

THE SPRING



PROVETRO IMPULS

THE SPRING

- FIGURES:**
- | | |
|-----------------------|------------------------------|
| Float 3mm: | Art.8030000/ 8030001 |
| Float powders | grain 0 in different colours |
| Dots 0026 16mm: | Art.3593705 |
| Dots 3122 8mm: | Art.3593730 |
| Stringer-Mix: | Art.3592999 |
| Contour line: | Art.5300100 |
| Jar sifter: | Art.3596001/ 3596000 |
| Fine dust respirator: | Art.3560715 |
| Glastac | Art.3562800 |
| Bullseye Paper: | Art.3550800 |

STEP 1

Transfer the paper template to the 3mm float glass. Cut out the shapes and fit them together. Due to the different overlaps, you will also get great effects when fused later.

Tip: If necessary, you can grind individual parts, eg with a Kristall 2000.5.



STEP 2

Decorate the shapes with the contour line pen. If the color is slightly, you can use a sharp cutter to make the contours sharp again after drying.

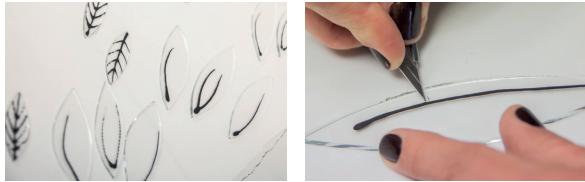

STEP 3

Powder each part in the matching color. (Please wear fine dust respirator!) If the contours are too obscured, carefully brush away the excess powder.

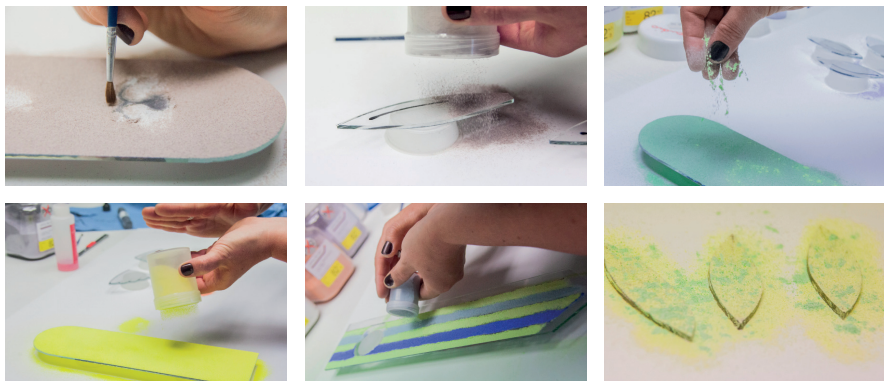

After powdering, prepare the dots for the eyes of the figures. To do this, glue the white dots with a little glue to the black dots and place them to the desired location.

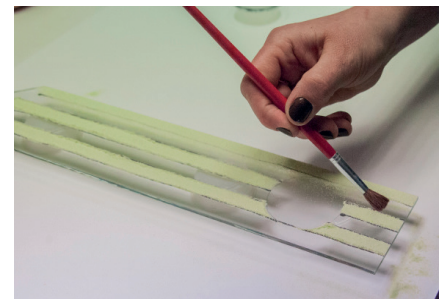
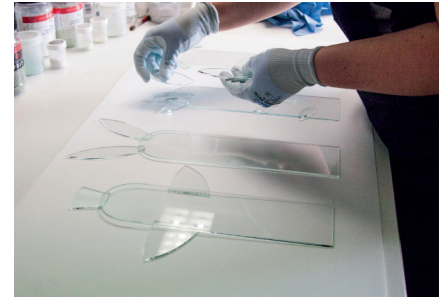
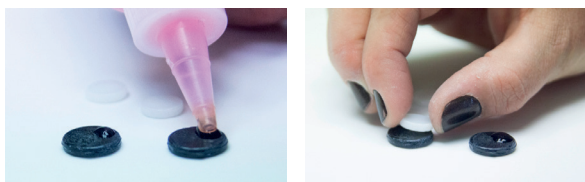

PROVETRO IMPULS

THE SPRING

STEP 4

Place a piece of Bullseye Paper into the kiln and carefully position the figures onto the paper.

FIRING CYCLE:

- | | | | |
|----|--------|---|-------|
| 1. | 120min | - | 500°C |
| 2. | skip | - | 800°C |
| 3. | 20min | - | 800°C |
| 4. | skip | - | 535°C |
| 5. | 120min | - | 535°C |
| 6. | 120min | - | 480°C |
| 7. | End | | |

STEP 5

Glue a suitable glass base for each figure and your individual spring decoration is finished!



Ear 2x

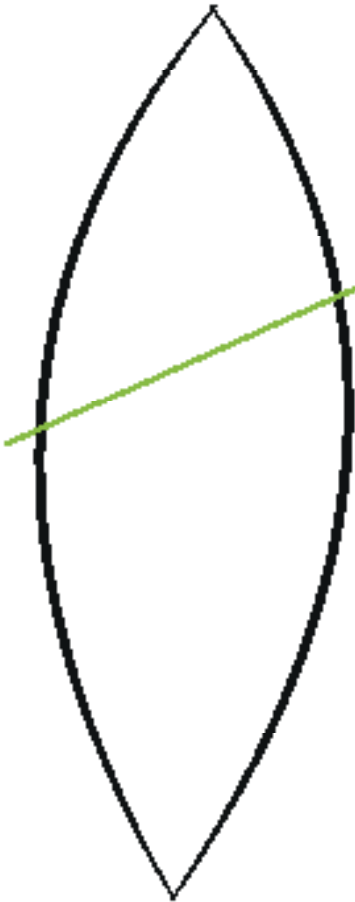

Cut line
for floppy ear

Eyes 4 Dots



Curved Stringers 6 units

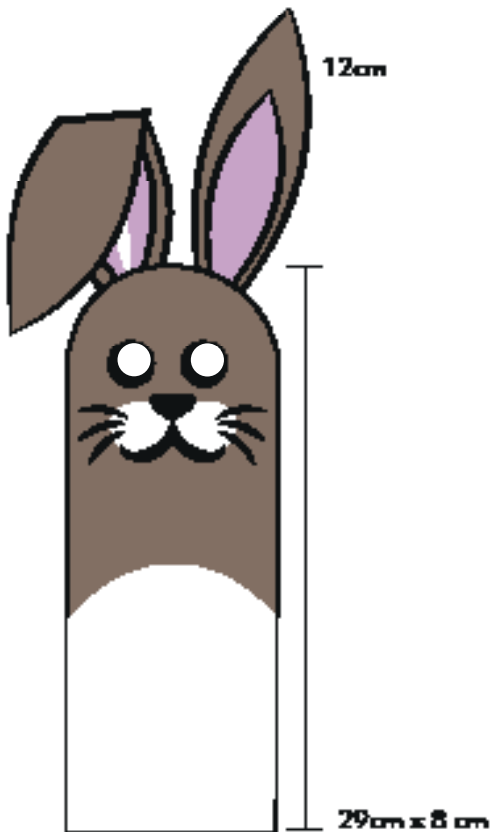

Scale 1 to 1

Wing 2x

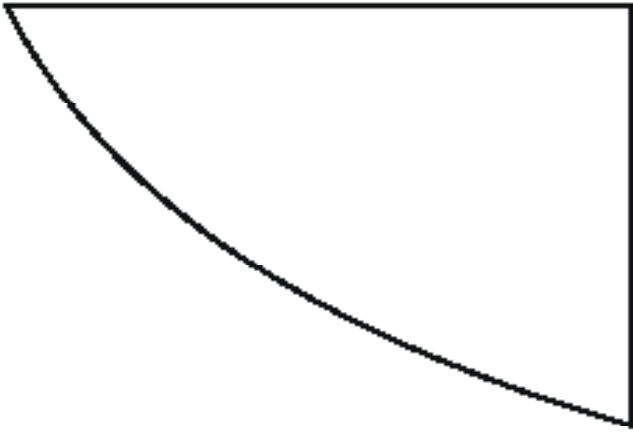

Crown 1x

Eyes 4 Dots

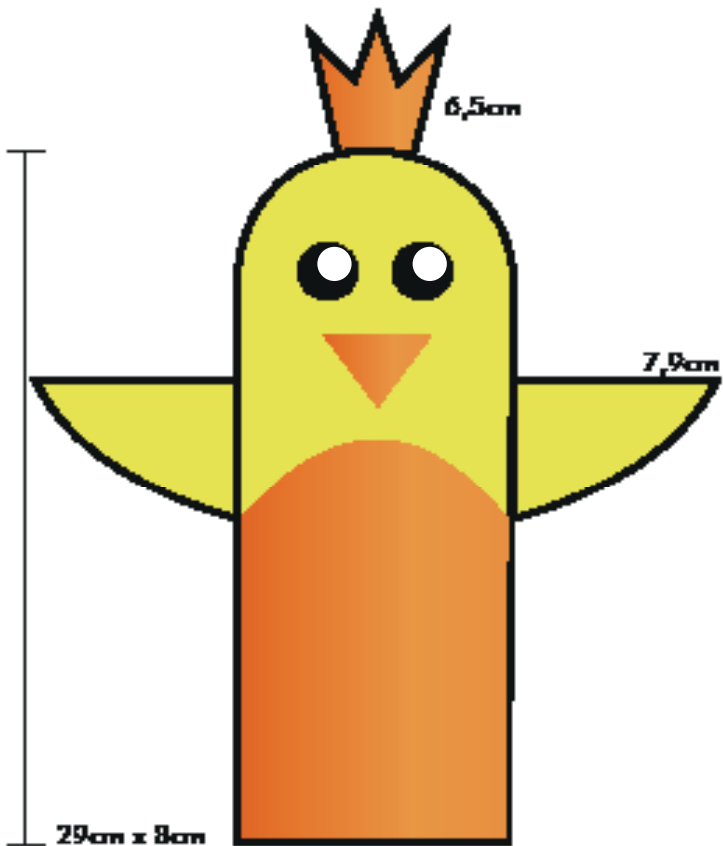
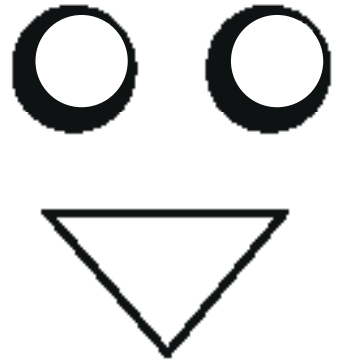

Scale 1 to 1

Leaf, huge 9x



Leaf, small 3x

Medium 1x

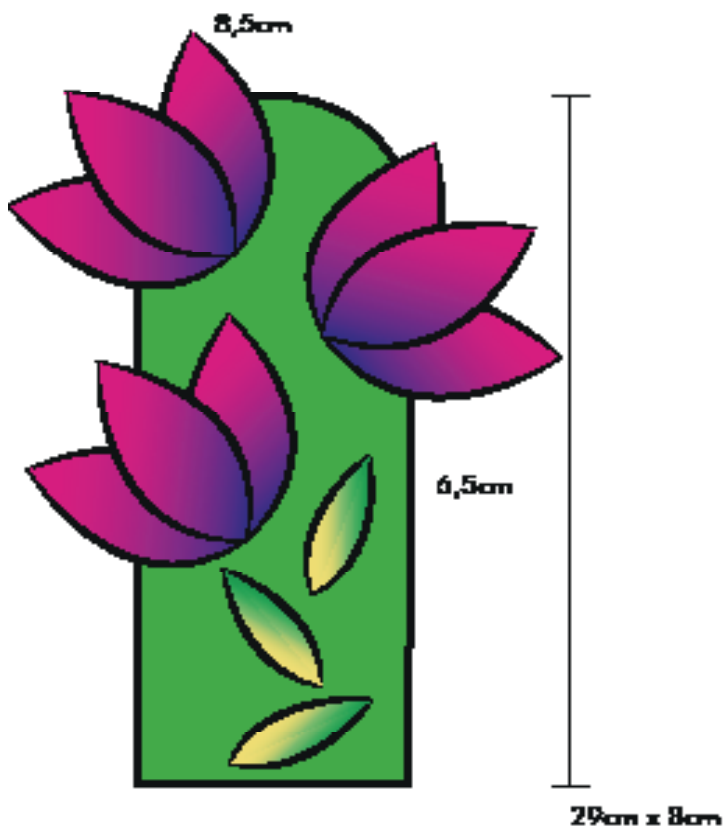
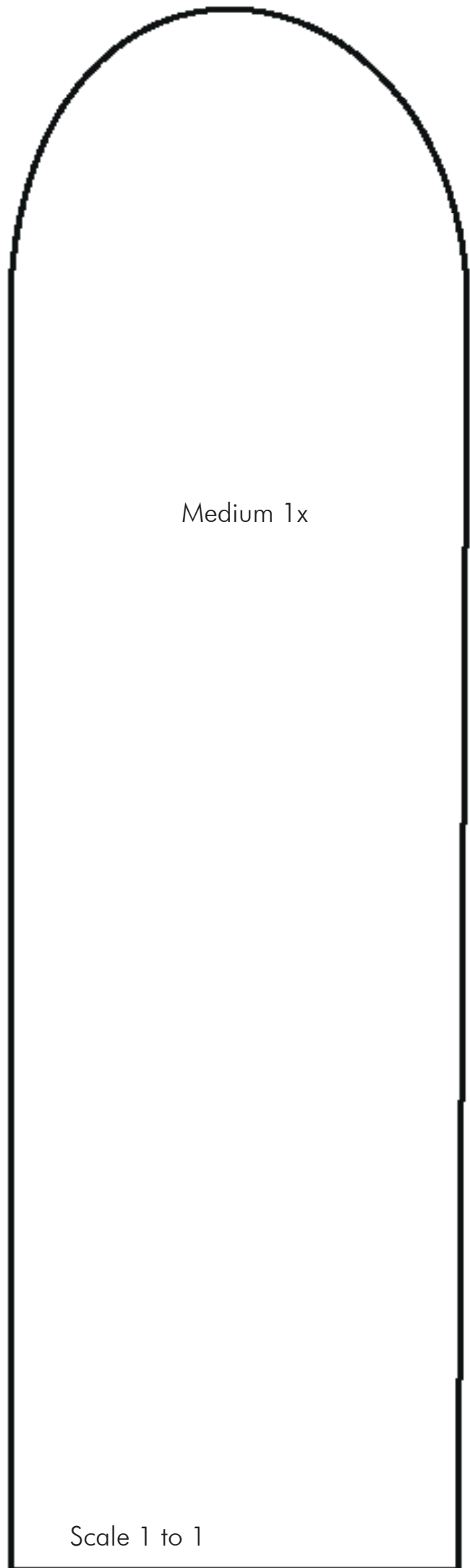

Scale 1 to 1

Roof 2x



Entrance 1x

